



Southampton to Deerfield (SHDF) Transmission Project Construction Notification

We are writing to inform you that the Southampton to Deerfield Transmission Project will begin conduit installation on **Willow Street** on or about **February 9, 2026**.

What You Can Expect:

- Location of Work:
 - **Willow Street**
- Work Hours:
 - The Project is permitted to work Monday through Saturday, 7:00 a.m. to 7:00 p.m.
- Construction Activities:
 - Conduit installation is anticipated to take 5-7 days
 - Vault Installation will follow for approximately 3 days.
- Traffic Management:
 - Willow Street will be closed during work hours except for local traffic for residents and deliveries.
 - The Project will coordinate closely with first responders to maintain a safe and effective flow of traffic around Project work areas and allow access for emergency services vehicles when needed.
 - Please see map of detour.

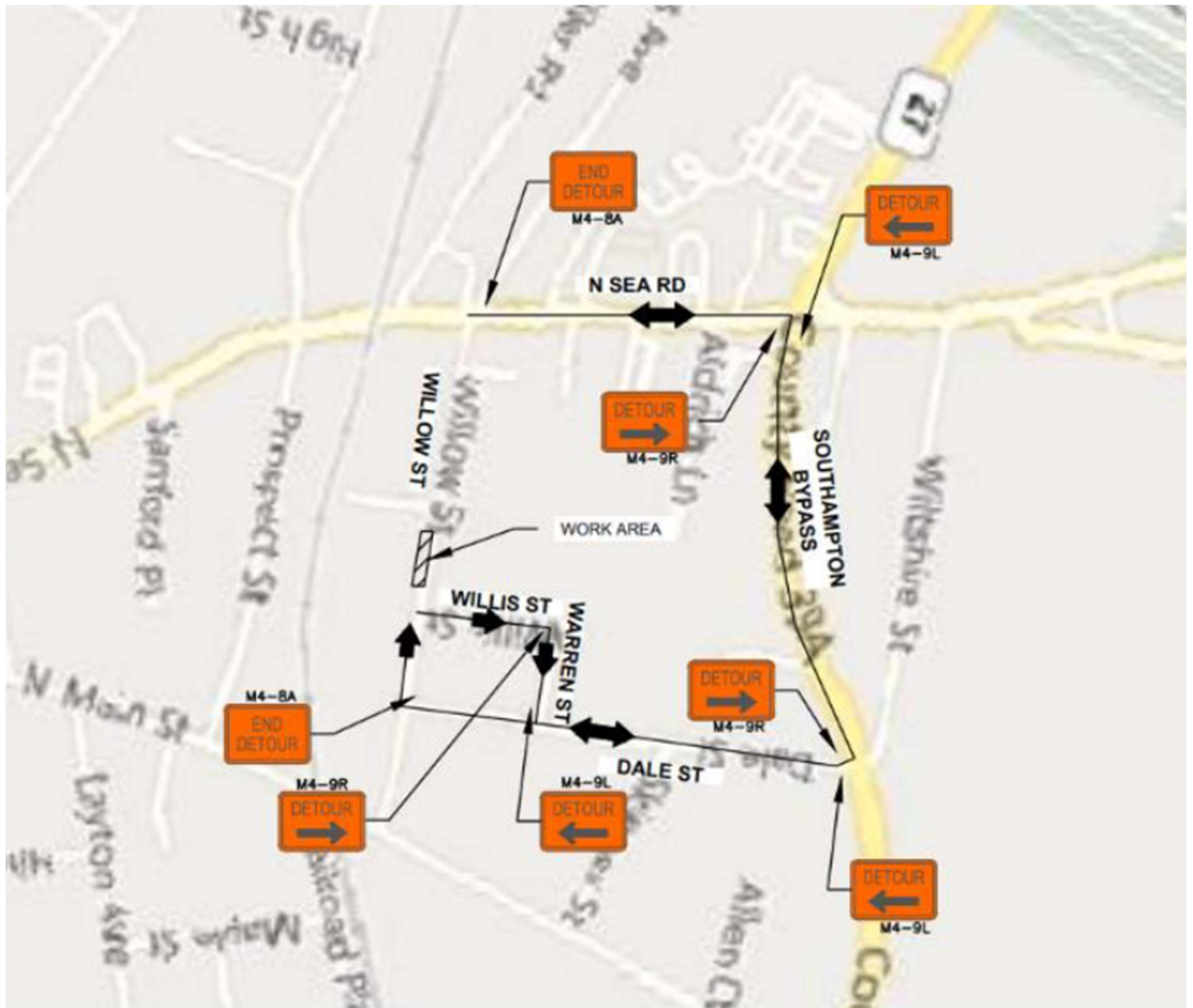

For questions about the SHDF Project, call or text 631-237-7196
Visit www.Southampton2Deerfield.com
Email: info@southampton2deerfield.com